

# PROJECT DATA

CLIENT: COSTCO WHOLESALE  
 999 LAKE DRIVE  
 ISSAQUAH, WA 98027

PROJECT ADDRESS: NE CORNER OF COIT ROAD &  
 CHURCHILL WAY, DALLAS, TX

## SITE DATA:

TOTAL SITE AREA: 13.29 ACRES (578,873 SF)

USE: GENERAL MERCHANDISE OR FOOD STORE 100,000 SF OR GREATER

SETBACKS:  
 FRONT: COIT 16 FEET  
 CHURCHILL 253 FEET  
 N. CENTRAL EXPRESSWAY 71 FEET  
 SIDE: 60 FEET  
 REAR: N/A

STRUCTURE HEIGHT: 34'-8"  
 STORIES: 1 STORY  
 LOT COVERAGE: 28%

## BUILDING DATA:

TOTAL FLOOR AREA: 150,437 SF  
 INCLUDES:  
 WAREHOUSE MAIN LEVEL 149,905 SF  
 OPTICAL 532 SF

## PARKING DATA:

OFF-STREET PARKING PROVIDED: 703 STALLS

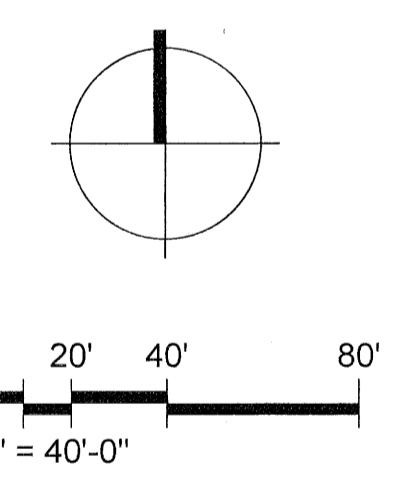
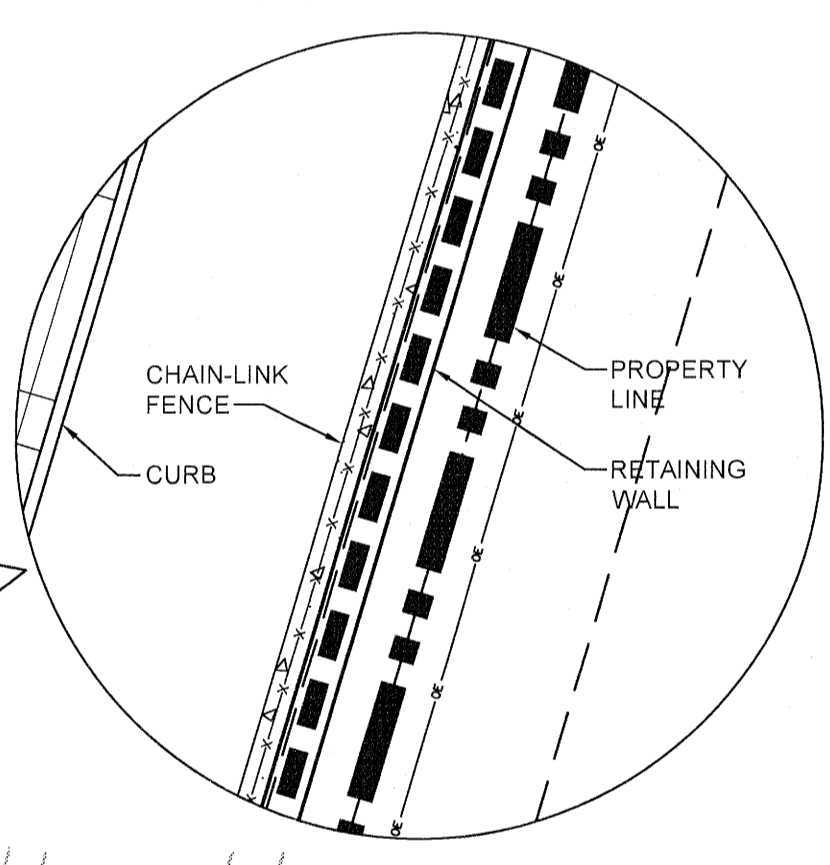
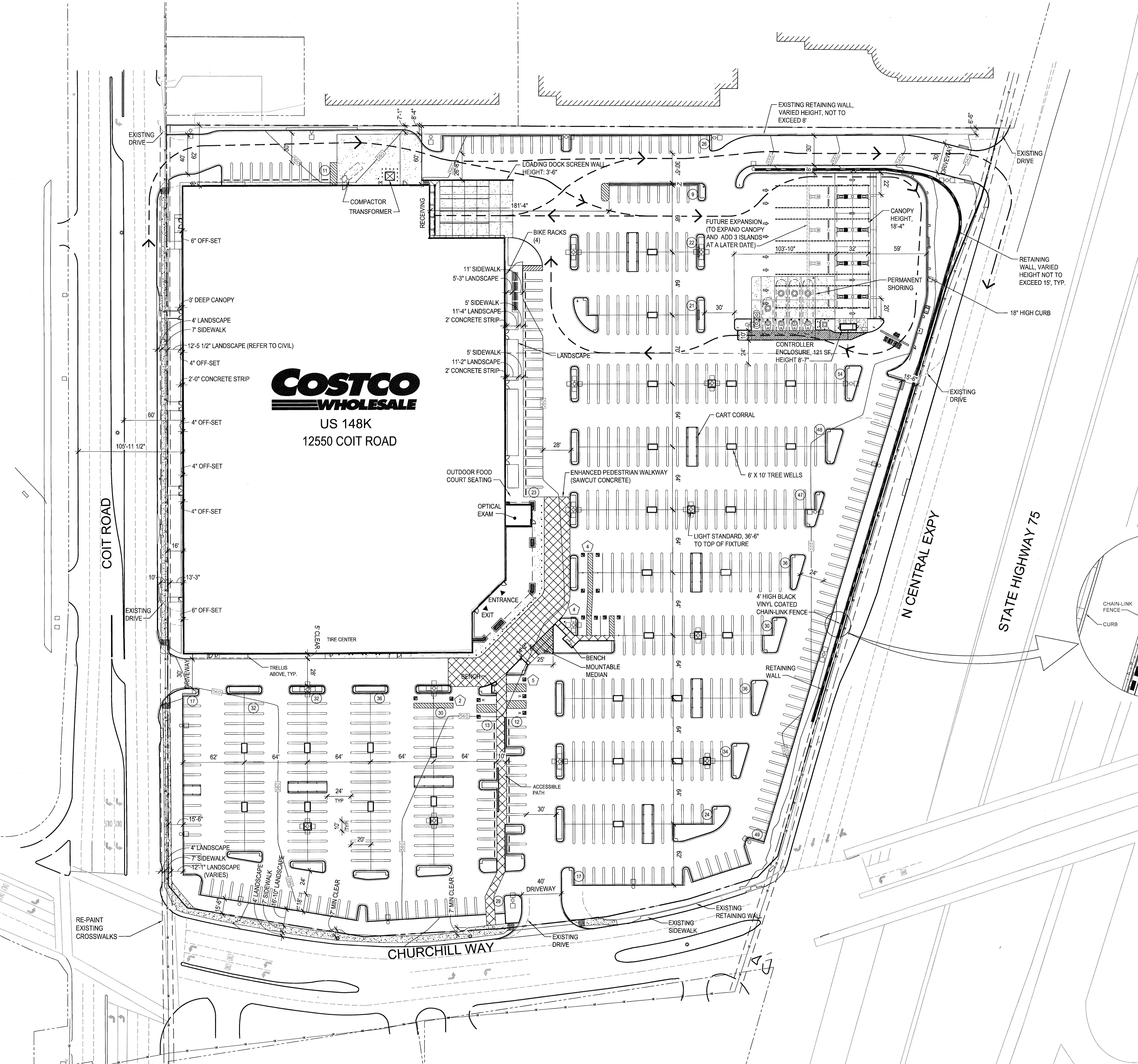

## VICINITY MAP

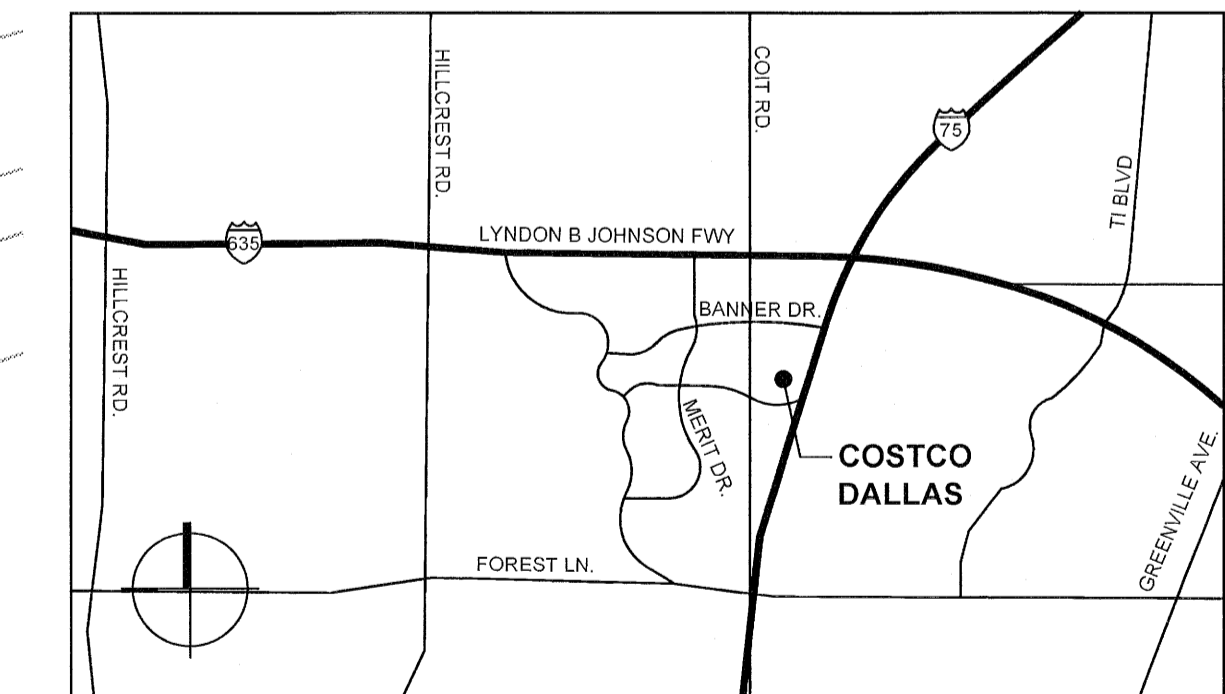

## REGIONAL MAP

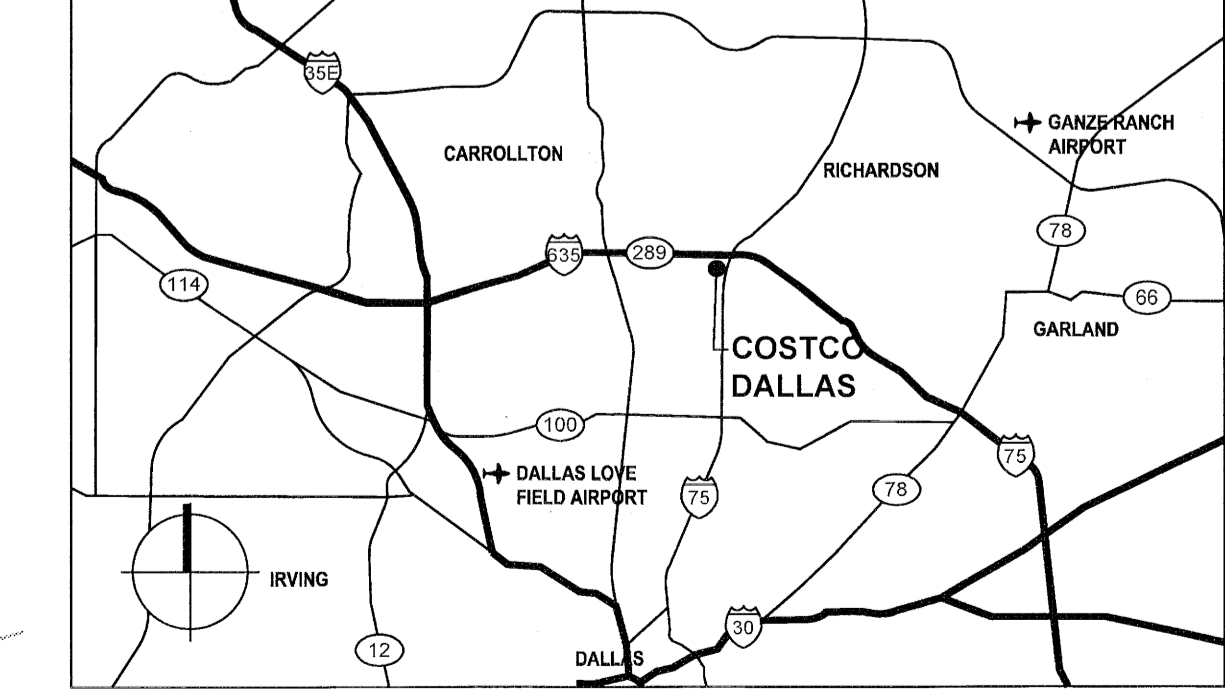

1101 Second Ave, Ste 100  
 Seattle, WA 98101  
 206 962 6500  
 MG2.com



13-0051-01  
 NOVEMBER 17, 2016

DEVELOPMENT PLAN

DD11-17

# COSTCO WHOLESALE DEVELOPMENT PLAN FILE NO. -Z156-191(RB)

DALLAS, TEXAS

NOVEMBER 17, 2016

©2016 All rights reserved. No part of this document may be reproduced in any form or by any means without permission in writing from MG2.